



HDS 1000 Be

Petrol-fuelled hot-water high-pressure cleaner with float tank, anti-scale protection, fuel shortage safeguard, steam level and infinitely variable pressure and water flow rate. Detergent mixture at high pressure. Electric and manual start.



1 Optimum ease of use

- Automatic burner cut-out in case of water shortage, overheating protection.
- Ergonomically designed trigger gun for ease of use.

2 Maximum performance

- High-output burner with upright heating coil and continuous ignition without deflagration.
- For removing stubborn deposits.



HDS 1000 Be

- Petrol engine with electric starter
- Easy Press trigger gun with soft grip and servo control
- Professional high-performance hot water unit

Technical data

Order No.		1.811-937.0
EAN code		4039784730564
Pressure	bar / MPa	40-210 / 4-21
Pressure	PSI	3000
Flow rate	l/h	450-900
Max. temperature	°C	98 / 80
Fuel oil consumption, full load	kg/h	5,6
Engine type		GX 390/Petrol
Power rating	kW / hp	9,5 / 13
Weight	kg	165
Dimensions (L x W x H)	mm	1100 x 750 x 785

Equipment

Trigger gun		Easy-press trigger gun
Trigger gun with Softgrip insert		■
High-pressure hose	m	15
Spray lance	mm	1050
Cage frame		■
Anti-twist system		■
Electric starter		■
Power nozzle		■
Servo Control		■
Sturdy tubular steel frame for handling with crane		■

■ Included in delivery.

ACCESSORIES FOR HDS 1000 BE

1.811-937.0

KÄRCHER



		Order No.	ID	Max. working pressure	Length	Price	Description	
Standard with unions on both sides								
High-pressure hose packaged	1	6.391-342.0	ID 8	315 bar	10 m			▲
High-pressure hose, 15 m DN 8, 315 bar, including rotary coupling	2	6.390-010.0	ID 8	315 bar	15 m		With rotary coupling, 2 x M 22 x 1.5	▲
High-pressure hose, 20 m DN 8, 315 bar, extension	3	6.390-031.0	ID 8	315 bar	20 m		With M 22x1.5 union at both ends and anti-kink protection ID 8/155°C/315 bar	▲
High-pressure hose, 30 m DN 8, including rotary coupling	4	6.390-293.0	ID 8	315 bar	30 m		With rotary coupling, 2 x M 22 x 1.5	▲
High-pressure hose, 15 m DN 10, 220 bar, extension	5	6.390-023.0	ID 10	220 bar	15 m		15 m high-pressure hose M 22 x 1.5) with kink protection and threaded couplings at both ends. Further data: DN 10/155°C/220 bar.	▲
Longlife 400 with unions on both sides								
High-pressure hose Longlife 400, 10 m, ID 8, including rotary coupling	6	6.388-083.0	ID 8	400 bar	10 m		10 m high-pressure hose Longlife 400 (DN 8) with rotary coupling, two layer high-strength steel wire reinforced. Connectors at both ends. M 22 x 1.5, with kink protection.	▲
High-pressure hose packaged	7	6.391-354.0	ID 8	400 bar	10 m			▲
High-pressure hose Longlife 400, 15 m, ID 8, including rotary coupling	8	6.389-709.0	ID 8	400 bar	15 m		With rotary coupling, 2 x M 22 x 1.5	▲
High-pressure hose Longlife 400, 20 m, ID 8, extension	9	6.390-027.0	ID 8	400 bar	20 m		with rotary coupling, 2 x M 22 x 1.5	▲
High-pressure hose Longlife 400, 30 m ID 8, including rotary coupling	10	6.390-294.0	ID 8	400 bar	30 m		With rotary coupling, 2 x M 22 x 1.5	▲
High-pressure hose 1.5 m, ID 8, including connectors	11	6.390-178.0	ID 8	400 bar	1.5 m		1.5 m high-pressure hose (DN 8, M 22 x 1.5) with kink protection and connectors at both ends. For connecting to hose reels with appropriate connector (M 22 x 1.5).	□
Food industry version with unions on both sides								
High-pressure hose, 10 m ID 8, suitable for food industry, extension piece	12	6.389-479.0	ID 8	250 bar	10 m		10 m high-pressure hose (DN 8) with patented (rotating) AVS trigger gun connector. Non-discolouring outer layer for use in the food industry. M 22 x 1.5 with anti-kink sleeve.	▲
High-pressure hose, 20 m ID 8, suitable for food industry, extension piece	13	6.389-581.0	ID 8	250 bar	20 m		20 m high-pressure hose (DN 8) with swivel coupling. Non-discolouring outer layer for use in the food industry. Connectors at both ends, M 22 x 1.5, with kink protection. NW 8/155°C/250 bar.	▲
Longlife food industry version with unions on both sides								
High pressure hose food ID 8 / 10 m	14	6.391-864.0	ID 8	400 bar	10 m		Longlife HP hose for use in the food industry. Außen-decke## animal-grease-resistant, non-colour-bleeding material. With rotary coupling, 2 x M 22 x 1.5	▲
High-pressure hose food industry 400 bar, 20 m, ID 8, including rotary coupling	15	6.391-887.0	ID 8	400 bar	20 m			▲
Standard								
High-pressure hose, 15 m DN 8, AVS trigger gun connector	16	6.390-185.0	ID 8	315 bar	15 m		15 m high-pressure hose (M 22 x 1.5) with kink protection. With patented rotating AVS trigger gun connector and manual coupling. Further data: DN 8/155°C/315 bar.	■
High-pressure hose, 10 m DN 8, AVS trigger gun connector	17	6.390-025.0	ID 8	315 bar	10 m		10 m high-pressure hose (M 22 x 1.5) with kink protection. With patented rotating AVS trigger gun connector and manual coupling. Further data: DN 8/155°C/315 bar.	□
High-pressure hose, 20 m DN 8, AVS trigger gun connector	18	6.390-171.0	ID 8	315 bar	20 m		20 m high-pressure hose (M 22 x 1.5) with kink protection. With patented rotating AVS trigger gun connector and manual coupling. Further data: DN 8/155°C/315 bar.	□
Longlife 400								
High-pressure hose packaged	19	6.391-351.0	ID 8	400 bar	10 m			□

■ Included in delivery. □ Available accessories. ▲ Extension hose.

ACCESSORIES FOR HDS 1000 BE

1.811-937.0

KÄRCHER



		Order No.	ID	Max. working pressure	Length		Price	Description	
High-pressure hose Longlife 400, 20 m DN 8, AVS trigger gun connector	20	6.390-208.0	ID 8	400 bar	20 m			20 m high-pressure hose Longlife 400 (DN 8) with patented (rotating) AVS trigger gun connector and manual coupling. Two layer high-strength steel wire reinforced.	<input type="checkbox"/>
Food industry version									
High-pressure hose, 10 m, ID 8, AVS trigger gun connection, food industry, grey	21	6.390-704.0	ID 8	250 bar	10 m			Food industry version, AVS connection in the trigger gun. grey NW 8/155 °C/250 bar	<input type="checkbox"/>
High-pressure hose, 20 m ID 8, AVS trigger gun connector, suitable for food industry, grey	22	6.390-705.0	ID 8	250 bar	20 m			20 m high-pressure hose (DN 8) with patented (rotating) AVS trigger gun connector. Non-discolouring outer layer for use in the food industry. NW 8/155°C/250 bar.	<input type="checkbox"/>
Longlife food industry version									
High-pressure hose Longlife 400, 10 m, ID 8, AVS trigger gun connection	23	6.391-885.0	ID 8	400 bar	10 m			Longlife HP hose for use in the food industry. Außen-decke## animal-grease-resistant, non-colour-bleeding material. With patented AVS connection in the pistol (pivot mounted)	<input type="checkbox"/>
High-pressure hose Longlife 400, 20 m, ID 8, AVS trigger gun connection	24	6.391-886.0	ID 8	400 bar	20 m				<input type="checkbox"/>
Special hoses									
High-pressure hose 1.5 m, ID 8, including connectors, outlet bend	25	6.388-886.0	ID 8	400 bar	1,5 m				<input type="checkbox"/>

■ Included in delivery. □ Available accessories. ▲ Extension hose.

ACCESSORIES FOR HDS 1000 BE

1.811-937.0

KÄRCHER



		Order No.	Flow rate				Price	Description	
Easy Press high-pressure gun with holding power reduction (Kärcher patent)									
Easy press high-pressure trigger gun with softgrip	1	4.775-463.0						Easy press high-pressure trigger gun with softgrip. For high-pressure hoses DN 6 and DN 8 with 11 mm swivel diameter.	■
Servo Control									
Servo control	2	4.775-470.0	750-1100 l/h						■
Trigger guns									
High end high-pressure trigger gun	3	4.775-823.0							□
Quick connect									
Quick coupling	4	6.401-458.0						For quick change of different spray lances and accessories. Optimum adaption to Kärcher accessories, especially for connection between trigger gun and spray lance. With M22 x 1,5 female.	□
Plug nipple	5	6.401-459.0						Hardened stainless steel nipple for quick coupling 6.401-458. With M22 x 1,5 male.	□

■ Included in delivery. □ Available accessories. ▲ Extension hose.

ACCESSORIES FOR HDS 1000 BE

1.811-937.0

KÄRCHER

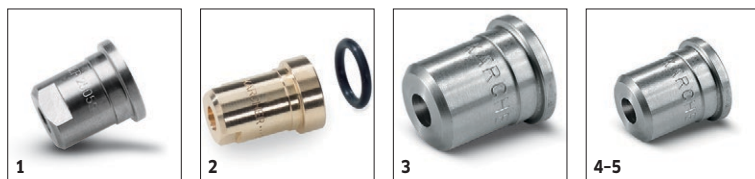

		Order No.	Nozzle size				Price	Description	
Power nozzle spray angle 25°									
Power nozzle spray angle 25°	1	2.883-894.0	47					Fan jet nozzle with 25° spray angle, suitable for large areas and removing stubborn dirt and stains.	■
	2	2.884-521.0	250						□
HP nozzle spray angle 0°									
High-pressure nozzle spray angle 0°	3	2.884-536.0	55					High-pressure nozzle with powerful jet for extremely stubborn dirt.	□
Power nozzle spray angle 15°									
Power nozzle spray angle 15°	4	2.883-390.0	55					Fan jet nozzle with 15° spray angle suitable for stubborn dirt.	□
Power nozzle spray angle 40°									
Power nozzle spray angle 40°	5	2.884-524.0	50					Power nozzle with a 40° spray angle and fan jet, suitable for large areas and sensitive surfaces.	□

■ Included in delivery. □ Available accessories. ▲ Extension hose.

ACCESSORIES FOR HDS 1000 BE

1.811-937.0

KÄRCHER



		Order No.	Max. working pressure	Length			Price	Description	
Rotating spray lances									
1050 mm lance, rotatable, ergonomic	1	4.760-660.0	300 bar	1050 mm				1050 mm stainless steel lance (manual coupling) with ergonomic handle for ease of use and protection. Rotatable 360° under pressure.	■
Rotatable lance, 600 mm, ergonomic	2	4.760-664.0	300 bar	600 mm				600 mm stainless steel lance (manual coupling) with ergonomic handle for ease of use and protection. Rotatable 360° under pressure.	□
Lance 850 mm, rotatable, ergonomic	3	4.760-663.0	300 bar	840 mm				850 mm stainless steel lance (manual coupling) with ergonomic handle for ease of use and protection. Rotatable 360° under pressure.	□
Lance 1550 mm, rotatable, ergonomic	4	4.760-661.0	300 bar	1550 mm				1550 mm stainless steel lance (manual coupling) with ergonomic handle for ease of use and protection. Rotatable 360° under pressure.	□
Lance 2050 mm, rotatable, ergonomic	5	4.760-662.0	300 bar	2050 mm				2050 mm stainless steel lance (manual coupling) with ergonomic handle for ease of use and protection. Rotatable 360° under pressure.	□
Spray lances									
Anti-vibration lance	6	6.415-951.0	250 bar	950 mm				The spring-loaded 360° loop handle significantly reduces the vibrations on the spray lance, reducing the physical burden on the user, e.g. when working with the dirt blaster.	□
Spray lance									
Lance 250 mm, non-rotatable	7	4.760-667.0		250 mm				250 mm stainless steel lance. With manual coupling. Non-rotatable.	□
Double lance									
Double lance 960 mm	8	6.394-665.0	310 bar	960 mm				960 mm double lance for variable pressure adjustment on handle at full water flow rate. Suitable for agricultural use (e.g. stable cleaning).	□
Variable pressure spray lance									
Variable pressure spray lance	9	4.760-362.0		670 mm				670 mm variable pressure lance with integrated pressure gauge. Variable pressure adjustment on the handle. Nozzle connector: M 24 x 1.5. Low pressure detergent application.	□
Variable pressure lance	10	4.760-230.0		1040 mm				1040 mm pressure adjustable lance with integrated pressure gauge. Variable pressure adjustment on the handle. Nozzle connector: M 24 x 1.5. Low pressure detergent application.	□
Adapter for variable pressure spray lance									
Adapter for variable pressure lance	11	4.762-075.0						For items 4.760-230 and 4.760-362 for mounting accessories to lance, M 24/18 x 1.5	□
Angular spray lance									
WC and gutter lance	12	4.760-073.0						Stainless steel lance WC and gutter with nozzle insert. Specially shaped for effective and hygienic cleaning of gutters and toilets.	□
Flexible spray lance									
Flexible lance 1050 mm	13	6.394-654.0	210 bar	1050 mm				1050 mm flexible lance with variable bend from 20° to 140°, ideal for cleaning difficult to reach areas, e.g. gutters.	□
Telescopic spray lance									
Telescopic jet pipe	14	6.394-690.0	225 bar						□
Restraint belt for telescopic jet pipe	15	6.373-987.0						Convenient strap for relief when working with the telescopic spray lance (6.394-690). The burden is optimally distributed on the body and longer periods of use are possible.	□

■ Included in delivery. □ Available accessories. ▲ Extension hose.

ACCESSORIES FOR HDS 1000 BE

1.811-937.0

KÄRCHER

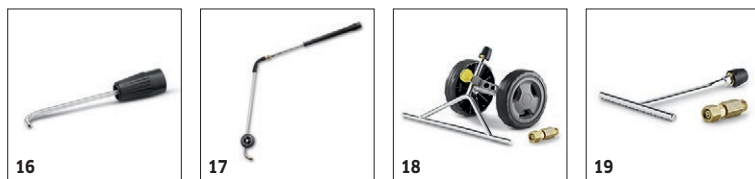

		Order No.	Max. working pressure	Length			Price	Description	
Gutter cleaner									
Gutter cleaning lance	16	2.642-305.0						The lance is suited for cleaning of gutter systems. Because of the shape of the lance and the special nozzle the gutter can be cleaned without removing the cover plates.	<input type="checkbox"/>
Undercarriage spray lance									
Underbody lance	17	4.760-245.0		700 mm				Stainless steel lance for effective and easy underbody and wheel arch cleaning. Without high-pressure nozzle.	<input type="checkbox"/>
Weed control									
WR 50	18	2.643-758.0							<input type="checkbox"/>
WR 20	19	2.643-760.0							<input type="checkbox"/>

■ Included in delivery. □ Available accessories. ▲ Extension hose.

ACCESSORIES FOR HDS 1000 BE

1.811-937.0



		Order No.					Price	Description	
Wheel mounting kit									
Practical kit with pneumatic tyres	1	2.637-820.0						Practical kit with pneumatic tyres for HDS 1000 BE and HDS 1000 DE high-pressure cleaners. For improved manoeuvrability.	<input type="checkbox"/>
Y distributor									
Y distributor	2	4.405-048.0							<input type="checkbox"/>

■ Included in delivery.
 ☐ Available accessories.
 ▲ Extension hose.

ACCESSORIES FOR HDS 1000 BE

1.811-937.0

KÄRCHER



		Order No.	Flow rate	Nozzle size	Diameter	Price	Description	
Hard surface cleaner FRV 30								
FRV 30	1	2.642-999.0						<input type="checkbox"/>
Extension hose 5 m	2	4.440-939.0					5m extension hose for FRV 30. Connection sleeve included.	<input type="checkbox"/>
Hard surface cleaner FR 30 ME								
FR 30 ME surface cleaner	3	2.640-355.0			300 mm		Hot water resistant stainless steel surface cleaner with double ceramic bearings, non-marking swivel castors and suction hose connection. Ideal for indoor cleaning, e.g. food industry.	<input type="checkbox"/>
Hard surface cleaner FR 50								
FR 50 surface cleaner	4	2.640-679.0			500 mm		Hot water resistant stainless steel surface cleaner with 500 mm working width. Ideal for large areas. With double ceramic bearings, push handle, non-marking swivel castors and detergent dosing system.	<input type="checkbox"/>
Machine-specific nozzle kit for FR								
Nozzle kit for surface cleaners (type-specific) 850 - 1100 l/h	5	2.640-442.0	850-1100 l/h				Nozzle kit includes power nozzles and unions. For Kärcher surface cleaners (850 to 1100 l/h).	<input type="checkbox"/>
Machine-specific nozzle kits for FRV								
Nozzle kit 050 for FRV 30	6	2.642-433.0		50				<input type="checkbox"/>
FRV 30 Me surface cleaner								
FRV 30 ME	7	2.642-911.0						<input type="checkbox"/>
Suction hose FRV 30 me	8	4.441-040.0						<input type="checkbox"/>
Flächenreiniger FR 50 Me								
	9	2.643-598.0						<input type="checkbox"/>

■ Included in delivery. □ Available accessories. ▲ Extension hose.

ACCESSORIES FOR HDS 1000 BE

1.811-937.0

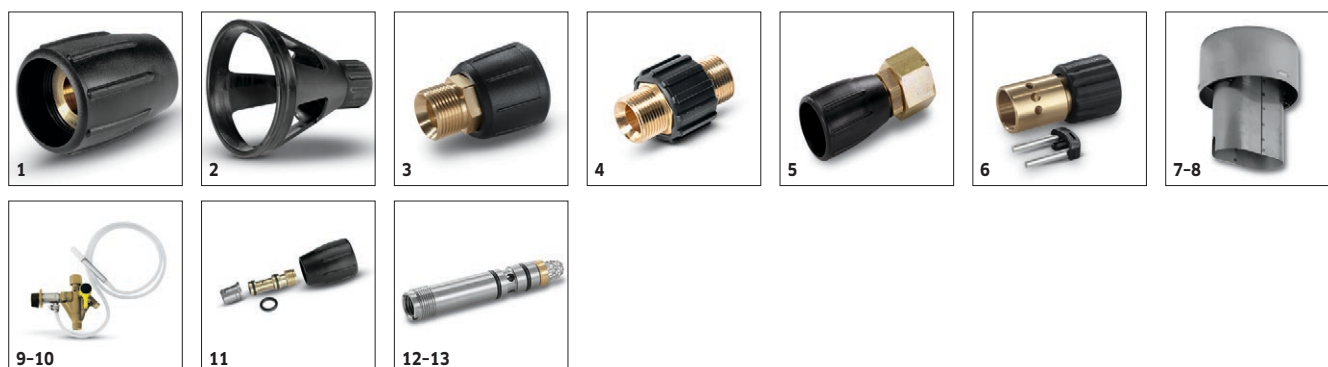
KÄRCHER

		Order No.					Price	Description	
Nozzle union									
Nozzle connector	1	5.401-210.0						For protecting and connecting Kärcher power nozzles to spray lances (M 18 x 1.5 IG).	<input type="checkbox"/>
Spacer (including nozzle union)									
Spacer (incl.nozzle union)	2	5.394-294.0						Guarantees constant safety clearance, e.g. for tyres and bodywork. Helps prevent damage to sensitive surfaces. Mounts directly to lance.	<input type="checkbox"/>
Rotary coupling									
Rotary coupling	3	4.401-091.0						Kärcher rotary coupling prevents twisting and kinking of high-pressure hoses for ease of use. Connector M 22 x 1.5 m. With grip protection.	<input type="checkbox"/>
Coupling									
Coupler -2xM22x1,5	4	4.403-002.0						Brass double connector for connecting and extending high-pressure hoses. With rubber protection. Connector: 2x M 22 x 1.5 m.	<input type="checkbox"/>
Connector									
Nozzle connector/screw connector	5	4.402-022.0						Nozzle connector/screw connector for connecting high-pressure nozzles and accessories to the high-pressure trigger gun (with nozzle connector). Connectors: 1x M 22 x 1.5 and 1x M 18 x 1.5.	<input type="checkbox"/>
Adapter									
Adapter M22 - Swivel	6	4.424-004.0						M22 x 1,5female and swivel connection. For extension of high-pressure hoses with AVS connection or for usage of the telescopic lance with a high-pressure hose with AVS connection.	<input type="checkbox"/>
Flue pipe									
Flue gas adapter	7	4.656-149.0						Flue gas adapter with draught damper for flue pipe connection (adapter for HDS burners for connection to a stack system).	<input type="checkbox"/>
	8	4.656-080.0							<input type="checkbox"/>
HP detergent injector									
Detergent injector for high pressure	9	3.637-170.0						Cleaning agent dosage at high pressure 3 - 5 %	<input type="checkbox"/>
Detergent injector for high and low pressure (without nozzles)	10	3.637-001.0						Detergent injector for independent high and low pressure dosage. Maximum dosage about 15%.	<input type="checkbox"/>
Machine-specific nozzle kit with order no. 3.637-170									
Machine-specific nozzle kit with order no. 3.637-170.0 750-1000 l/h	11	4.769-047.0						For HD/HDS 750 - 1000 l/h. Consists of nozzle insert + HP power nozzle + union	<input type="checkbox"/>
Nozzle insert with order no. 3.637-001									
High pressure for units rated 1100 l/h or more	12	4.769-002.0						For high pressure with machines above 1.100 l/h	<input type="checkbox"/>
Low pressure for units rated 1100 l/h or more	13	4.769-006.0						For low pressure with machines above 1.100 l/h	<input type="checkbox"/>

■ Included in delivery. □ Available accessories. ▲ Extension hose.

ACCESSORIES FOR HDS 1000 BE

1.811-937.0

KÄRCHER

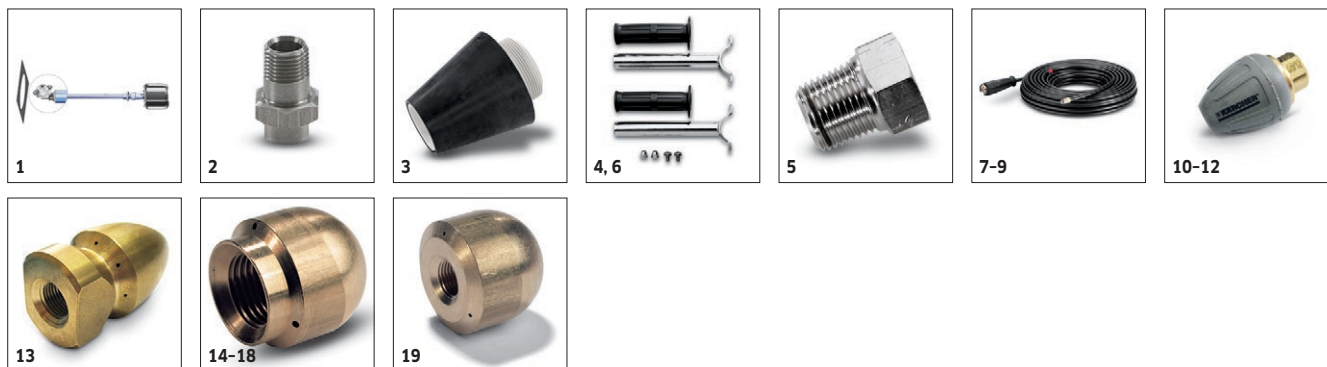

		Order No.	Max. working pressure	Nozzle size	Diameter	Price	Description	
HKF 50 spray head, brass								
HKF 50 spray head , brass	1	3.631-039.0					Depth of immersion 850 mm. Interior cleaning head for barrels and containers with bungholes of 50 mm and more. Can be directly connected to the high-pressure cleaner. Electric motor drive. Operation is possible both vertically and horizontally	<input type="checkbox"/>
Nozzle kit for HKF 50 spray head (3.631-009.0 / 3.631-039.0)								
Nozzle 030 for dual nozzle operation HKF 50	2	6.415-444.0		30			Nozzle for dual-nozzle operation	<input type="checkbox"/>
Cone for plugging into bungholes	3	4.132-002.0					Cone for plugging into bungholes	<input type="checkbox"/>
Double handle for exact control of the spray head	4	2.863-036.0					Double handle. Precise control of the spray head	<input type="checkbox"/>
Screw plug for using a spray head with one nozzle	5	5.411-061.0					Screw plug for using a spray head with one nozzle	<input type="checkbox"/>
Nozzle 070 for HKF 50	6	6.415-077.0		70			Nozzle for dual-nozzle operation	<input type="checkbox"/>
Pipe cleaning hose, ID 6								
Pipe cleaning hose	7	6.390-028.0	120 bar				20 m flexible high-pressure hose (DN 6) for cleaning pipes (threaded connection for R 1/8 nozzle).	<input type="checkbox"/>
Pipe cleaning hose, DN 6, 30 m	8	6.390-029.0	120 bar				30 m flexible high-pressure hose (DN 6) for cleaning pipes (threaded connection for R 1/8 nozzle).	<input type="checkbox"/>
Pipe cleaning hose, DN 6, 20 m, 220 bar	9	6.390-030.0	250 bar				20 m flexible high-pressure hose (DN 6) for cleaning pipes up to 220 bar (threaded connection for R 1/8 nozzle).	<input type="checkbox"/>
Pipe cleaning nozzle								
Drain cleaning dirt blaster D 25/060	10	6.415-945.0		60	25 mm		The forward-tilted rotating pencil jet removes the most stubborn dirt. The three backwards-tilted jets ensure the necessary forward movement, as well as convenient handling.	<input type="checkbox"/>
Drain cleaning dirt blaster D 30/060	11	6.415-947.0		60	30 mm			<input type="checkbox"/>
Drain cleaning dirt blaster D 35/060	12	6.415-949.0		60	35 mm			<input type="checkbox"/>
Nozzle pipe cleaning size 80	13	5.763-087.0		80	25 mm		Pipe cleaning nozzle with 24 mm diameter. With 4 nozzles tilted back at a 30° angle.	<input type="checkbox"/>
Pipe cleaning nozzle	14	5.763-015.0		55	16 mm		16 mm pipe cleaning nozzle with internal thread. Various jet directions for environmentally-friendly cleaning of blocked drains and pipes.	<input type="checkbox"/>
	15	5.763-019.0		65	16 mm			<input type="checkbox"/>
	16	5.763-016.0		60	16 mm			<input type="checkbox"/>
	17	5.763-020.0		65	16 mm			<input type="checkbox"/>
	18	5.763-017.0		50	30 mm		30 mm pipe cleaning nozzle with internal thread. Various jet directions for environmentally-friendly cleaning of blocked drains and pipes.	<input type="checkbox"/>
	19	5.763-021.0		70	30 mm			<input type="checkbox"/>

■ Included in delivery. □ Available accessories. ▲ Extension hose.

ACCESSORIES FOR HDS 1000 BE

1.811-937.0

KÄRCHER



		Order No.	Max. working pressure	Nozzle size			Price	Description	
Angle vario nozzle 0°-90°									
Spezial nozzle 0005	1	4.763-039.0		50				Variable angle nozzle for spray angle adjustment from 0° to 90°. For easy adjustment to all kinds of soiling and surfaces.	<input type="checkbox"/>
Dirt blaster, large									
Dirt blaster - without changeover function	2	4.763-253.0	300 bar	50				The dirt blaster with rotating pencil jet offers 10 times better cleaning performance. Ceramic nozzle and bearing ring for a long service life. Further data: Max. 300 bar, 30 MPa, 85°C.	<input type="checkbox"/>
Inaktiv									
Dirt blaster - with changeover to low pressure cleaning agent intake	3	4.763-951.0	300 bar	50					<input type="checkbox"/>
Inaktiv									
Dirt blaster with changeover to fan jet	4	4.763-957.0	300 bar	50					<input type="checkbox"/>

■ Included in delivery. □ Available accessories. ▲ Extension hose.

ACCESSORIES FOR HDS 1000 BE

1.811-937.0

KÄRCHER



		Order No.	Nozzle size				Price	Description	
Wet blasting attachment (without nozzle)									
Wet blasting attachment with flow control (without nozzles)	1	4.762-010.0						Paint, rust and scale removal made easy: Kärcher wet blasting attachment with flow control for adding blasting abrasive to the high-pressure jet.	<input type="checkbox"/>
Wet blasting attachment without flow control (nozzles not included)	2	4.762-022.0						Paint, rust and scale removal made easy: Kärcher wet blasting attachment with flow control for adding blasting abrasive to the high-pressure jet. Without flow control.	<input type="checkbox"/>
Nozzle pack for wet blasting attachment									
Nozzle kit for wet blasting attachment 050	3	2.637-902.0	50					Nozzle kit with wet blasting nozzle and nozzle insert (type specific). For optimal Kärcher wet blasting attachment performance. Only in combination with wet blasting attachment 4.762-010/-022.	<input type="checkbox"/>
Boron carbide nozzle									
Boron carbide nozzle, for machines as of 1000 l/h	4	6.415-084.0	6 mm					In addition to nozzle packs. Very wear-resistant nozzle with boron carbide chuck for continuous-duty operation.	<input type="checkbox"/>

■ Included in delivery. □ Available accessories. ▲ Extension hose.

ACCESSORIES FOR HDS 1000 BE

1.811-937.0

KÄRCHER

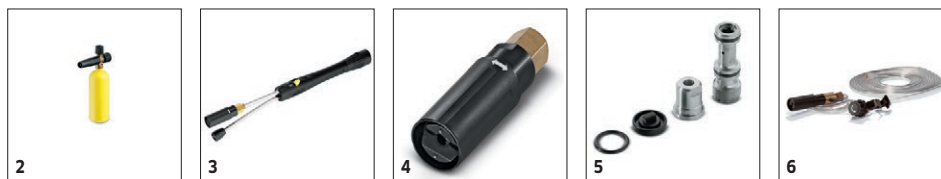

		Order No.	Flow rate				Price	Description	
Cup foam lance									
Tank 1L	1	6.414-954.0							<input type="checkbox"/>
Cup foam lance	2	6.394-668.0	1200 l/h					Short, handy foam lance with adjustable spray angle with 1 litre detergent tank. Ideal for cleaning cars due to its compact design.	<input type="checkbox"/>
Inno Foam Kit									
Inno foam kit	3	2.640-692.0						High-pressure foam system with double lance (foam nozzle and high-pressure jet for rinsing). For use with mobile and stationary high-pressure and HDS pressure cleaners for cleaning or disinfection.	<input type="checkbox"/>
Easy Foam Set									
Easy foam set	4	2.640-693.0						HP foam system for use with. HD/HDS units for cleaning and disinfecting. Foam nozzle for connection to lance and HP chemical injector with precision 0-5% metering valve. The machine specific nozzle kit has to be ordered separately.	<input type="checkbox"/>
Nozzle kits for Inno/Easy Foam Set									
Nozzle kit 090 Inno/Easy kit 700 - 1000 l/h	5	2.640-688.0	700-1000 l/h					Nozzle kit contains Kärcher power nozzles and nozzle inserts. For Inno/Easy-Foam set 700-1000 l/h. For optimal foam system performance.	<input type="checkbox"/>
Foam nozzle mounting kit									
Foam nozzle kit	6	2.637-926.0						Foaming agent kit. The foam nozzle is ideal for use in sanitary areas and the food industry and wherever long application times are necessary.	<input type="checkbox"/>

■ Included in delivery. □ Available accessories. ▲ Extension hose.

ACCESSORIES FOR HDS 1000 BE

1.811-937.0

KÄRCHER



		Order No.	Length					Price	Description	
Hose reel add-on kit										
Hose reel kit for HDS 801/1050 B/D	1	2.637-733.0	20 m						ABS hose reel for mounting on the machine. For safe and tidy stowage of high-pressure hoses (with connecting hose to machine's HP outlet). Can be rotated under pressure, with M 22 x 1.5 connection.	<input type="checkbox"/>
Automatic, self-winding hose reels										
Swivel holder	2	2.639-931.0							Swivel holder for automatic hose reel wall mounting. For maximum action radius and flexibility of high-pressure hose. Rotatable 120°. Galvanised steel.	<input type="checkbox"/>
ABS wall fastening stainless steel	3	2.641-867.0							Swivelling wall bracket made of high-grade steel (for 2.641-866). This makes maximum flexibility and convenience possible when working with the HP hose.	<input type="checkbox"/>
Add-on kit hose reel plastics	4	6.392-975.0	20 m						Automatic hose reel for 20 m high-pressure hose. The console is made from powder-coated steel, the drum is made from plastic.	<input type="checkbox"/>
Add-on kit hose reel	5	6.392-965.0	20 m						Automatic hose reel for 20 m high-pressure hose. The console consists of stainless steel, the drum is made from plastic.	<input type="checkbox"/>
Hose reel, automatic, 20 m, painted	6	2.639-919.0	20 m						Automatic hose reel of durable plastic. Painted steel bracket. Suitable for 20 m high-pressure hose.	<input type="checkbox"/>
Hose reel, automatic, 20 m, stainless steel	7	6.391-421.0	20 m						Automatic stainless steel hose reel. With swivel holder. Suitable for 20 m high-pressure hose.	<input type="checkbox"/>
ABS hose reel stainless steel	8	2.641-866.0	20 m						High-grade, automatic steel hose reel. Especially suitable for use in the food industry. The material and finish provide for a corrosion-resistant, watertight capsuled sprong drive. Connection for HP hoses with nipple.	<input type="checkbox"/>

■ Included in delivery. □ Available accessories. ▲ Extension hose.

ACCESSORIES FOR HDS 1000 BE

1.811-937.0

KÄRCHER

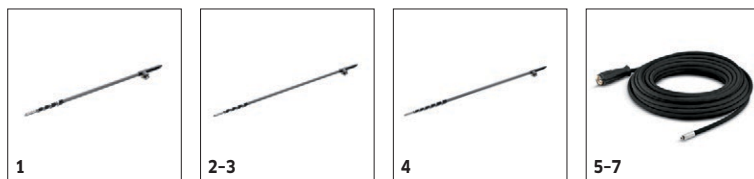

		Order No.	Flow rate	Feed temperature	Length	Length	Price	Description	
Solar cleaning - telescopic lances									
iSolar TL 7 H (without hose)	1	4.107-054.0		60 °C				Telescopic rod made from a carbon/fibreglass mixture for maximum rigidity with minimum weight. With 7.2 m max. reach and practical quick-release couplings for easy extension and retraction.	<input type="checkbox"/>
Telescopic rod complete 10m	2	4.107-053.0		60 °C				Telescopic rod made from a carbon/fibreglass mixture for maximum rigidity with minimum weight. With 10 m max. reach and practical quick-release couplings for easy extension and retraction.	<input type="checkbox"/>
Telescopic rod complete 10m CFK	3	4.107-055.0		60 °C					<input type="checkbox"/>
Telescopic rod complete 14m	4	4.107-052.0		60 °C				Full carbon telescopic rod for maximum rigidity with minimal weight. With 14 m max. reach and practical quick-release couplings for easy extension and retraction.	<input type="checkbox"/>
Hose solar	5	6.392-978.0		155 °C				High-quality, flexible HP hose (with rubber covering) for the iSolar TL 7. The outer layer has especially good sliding properties when extending and retracting the telescopic rod.	<input type="checkbox"/>
	6	6.392-977.0		155 °C				High-quality, flexible HP hose (with rubber covering) for the iSolar TL 10. The outer layer has especially good sliding properties when extending and retracting the telescopic rod.	<input type="checkbox"/>
	7	6.392-976.0		155 °C				High-quality, flexible HP hose (with rubber covering) for the iSolar TL 14. The outer layer has especially good sliding properties when extending and retracting the telescopic rod.	<input type="checkbox"/>

■ Included in delivery. □ Available accessories. ▲ Extension hose.

ACCESSORIES FOR HDS 1000 BE

1.811-937.0



		Order No.	Flow rate				Price	Description	
Rotating washing brush									
Washing brush rotary	1	4.762-560.0	500-800 l/h						<input type="checkbox"/>
	2	4.762-561.0	500-800 l/h						<input type="checkbox"/>

■ Included in delivery. □ Available accessories. ▲ Extension hose.

ACCESSORIES FOR HDS 1000 BE

1.811-937.0

KÄRCHER



		Order No.	Length	Diameter			Price	Description	
Geka coupling									
With hose nozzle, R 3/4"	1	6.388-455.0						with hose liner	<input type="checkbox"/>
With hose nozzle, R 1"	2	6.388-465.0							<input type="checkbox"/>
Hose coupling	3	6.388-458.0						with female thread	<input type="checkbox"/>
Suction filter									
Water filter	4	6.414-956.0							<input type="checkbox"/>
Suction filter with check valve	5	4.730-012.0						Brass suction filter suitable for ponds, storage tanks, etc. With check valve.	<input type="checkbox"/>
Fine-mesh water filter									
Fine-mesh water filter, 100 µm, R 3/4"	6	2.637-691.0						Fine-mesh water filter, 100 µm, max. temperature 60°C. Protects the high-pressure cleaner from dirt particles contained in the water. Transparent filter cup. Water flow rate up to 1200 l/h. Connector 3/4".	<input type="checkbox"/>
	7	2.638-255.0						Mounts to machine, suitable for pressure and suction mode, 90-120 µm	<input type="checkbox"/>
Fine-mesh water filter with adapter	8	4.730-102.0						Fine-mesh water filter, 125 µm, max. temperature 50°C. Protects the high-pressure cleaner from dirt particles contained in the water. Water flow rate up to 1200 l/h. Connection 3/4", with adapter, 1".	<input type="checkbox"/>
Fine-mesh water filter, 100 µm, R 1"	9	2.638-270.0						Fine-mesh water filter, 100 µm, max. temperature 60°C. Connects to high-pressure cleaner. Protects the high-pressure cleaner from dirt particles contained in the water. Water flow rate up to 1200 l/h. Connector 1".	<input type="checkbox"/>
Water supply hose									
Water supply hose	10	4.440-207.0	7,5 m					NW 19 R1" / R 3/4", up to 85 °C, for pick-up	<input type="checkbox"/>

■ Included in delivery. □ Available accessories. ▲ Extension hose.